

A

CNC punching and shearing lines for the processing of angles

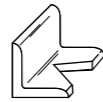
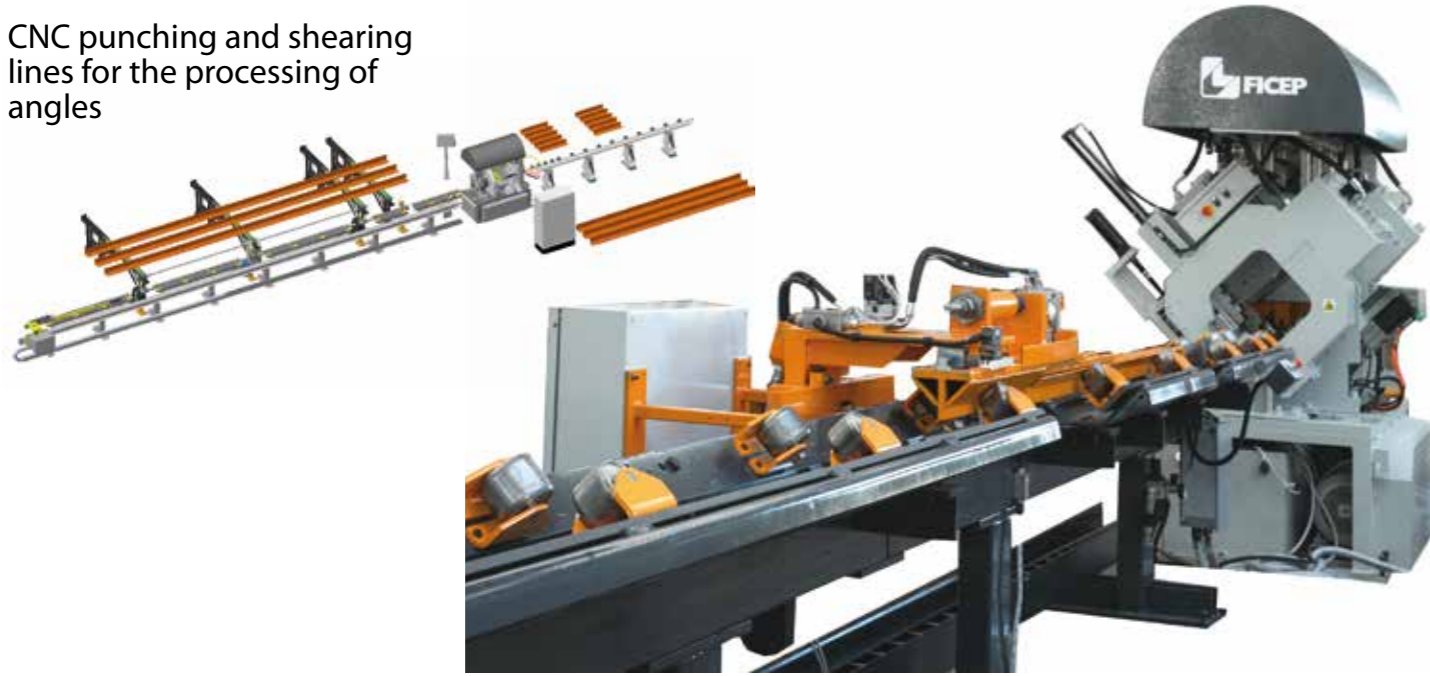

The customer can easily configure a line to address their specific requirements:

- Infeed and outfeed idle roller conveyors of various lengths
- Rotary loaders for the automatic loading of angles onto the system's infeed table and powered material advance system
- Part unloading system
- CNC programmable marking or cartridge style marking
- Optional press with interchangeable tools to address additional fabrication requirements, like notching, marking or punching.

TECHNICAL CHARACTERISTICS

MODEL		A102	A162	A164	A166	A204	A206
Min angle size	Inch	1-3/16" x 1-3/16" x 1/8"	1-3/16" x 1-3/16" x 1/8"	1-5/8" x 1-5/8" x 3/16"	1-5/8" x 1-5/8" x 3/16"	1-5/8" x 1-5/8" x 3/16"	1-5/8" x 1-5/8" x 3/16"
Max angle size	Inch	4" x 4" x 1/2"	6" x 6" x 9/16"	6" x 6" x 3/4"	6" x 6" x 3/4"	8" x 8" x 1"	8" x 8" x 1"
Diam. per leg	No.	1	1	2	3	2	3
Punching force	US Tons	55	72	88	88	110	110
Max diameter	Inch	1-1/4"	1-1/4"	1-1/4"	1-1/4"	1-1/4"	1-1/4"
Shearing force	US Tons	110	192	242	242	495	495

Please review FICEP's terms and conditions of sale and system specifications that are in our formal proposal. The manufacturer reserves the right to change specifications and features from those indicated in this brochure. Current specifications and features are part of the formal quotation.



FICEP S.p.A. - HEADQUARTERS
 via Matteotti, 21 • 21045 GAZZADA SCHIANO VA - ITALY
 Tel +39 0332 876111 • Fax +39 0332 462459
 E-mail: ficep@ficep.it • www.ficepgroup.com



FICEP CORPORATION
 2301 Industry Court - Forest Hill Industrial Park
 Forest Hill, MD 21050
 Tel (410) 588-5800 • Fax (410) 588-5900
 E-mail: info@ficepcorp.com • www.ficepcorp.com

08-2016 Advanced Agency VA



A

CNC punching and shearing lines for the processing of angles



MADE IN ITALY



A
CNC punching and shearing lines for the processing of angles



The "A" series angle lines in the Ficep range are equipped with a roller feed drive and measuring system that has been engineered for the production of typical detail parts. The roller feed design is compact in design and features full floating (vertically and horizontally) of both drive and measuring wheels as stock angle material is not always straight.

The punch presses are of a bridge press design and are fixed to the machine bed for maximum stability. Just the Quick Change Tool Holder (which can be changed in seconds) is automatically positioned to the programmed gauge line. All tools are moved independently in masked time to provide the most productive results possible on a roller feed angle line.

The complete family of A Series angle lines from FICEP can be configured to address the processing of flats and channels with the optional quick change shear tooling. Other optional items can be configured in the line to further enhance the material handling efficiency.



Pegaso is the new generation CNC for Ficep machines. PC, CNC and PLC are all integrated on a single board to have the maximum reliability and simplicity. Pegaso is based on field bus technology: Can Bus and Ether CAT, with up to 32 axes controlled.



38-character rotary marking unit



The "A" Series Models are available in three different sizes to cover the full range of angles typically used in steel fabrication. The models can typically be furnished with 1, 2 or 3 different tools (diameters) per angle leg. Each tool is positioned to the programmed gage line rapidly with a ball screw positioning system which generally occurs in masked time while one of the other tools is used for punching.

The Ficep CNC "A" Series angle lines are also available with a double cut shear to reduce the initial investment without sacrificing the cut quality.



Quick-change blade holder



Angle infeed system with roller

